



12-14 Burgundy Drive Morayfield QLD

6 2 4

Set upon an elevated 3,000sqm allotment in the highly sought after Excelsior Park Estate, this beautiful acreage residence is the one you've been waiting for!

This spectacular home boasts 9ft high ceilings, 6 spacious bedrooms, multiple internal living spaces, new fireplace, saltwater inground pool with pool house, outdoor bath and shower (amongst the palms), 5.6m x 5.8m powered shed (which has been converted to air-conditioned offices with kitchenette), 13kW solar and your own sauna!

Upon entering this delightful abode, you will note the large entry way, soaring high ceilings, beautiful timber flooring, spacious living room with brand new curtains, Plantation Shutters, views over your fabulous saltwater inground pool, surrounded by beautiful established gardens!

Price : \$ 1,200,000
Land Size : 3000 sqm
View : <https://www.generatere.com.au/7798936>



Erica Swannell
07 3639 0161

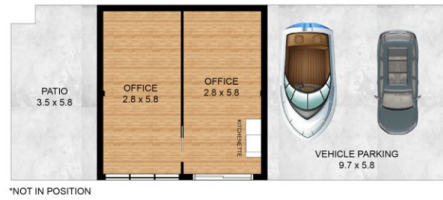

FLOOR PLAN

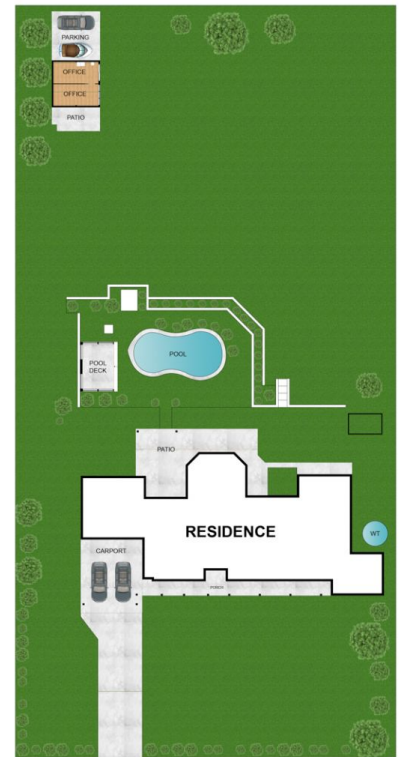

SITE PLAN

12-14 Burgundy Drive, **MORAYFIELD**

Int: 275sqm | Ext: 129sqm | Car: 98sqm | Total: 502sqm



DISCLAIMER: THIS FLOOR PLAN IS FOR ILLUSTRATIVE PURPOSES ONLY. WHILST EVERY ATTEMPT HAS BEEN MADE TO ENSURE THE ACCURACY OF THIS FLOOR PLAN, ALL MEASUREMENTS ARE APPROXIMATE ONLY. NO RESPONSIBILITY IS TAKEN FOR ANY ERRORS, OMISSION OR MISS-STATEMENT. POTENTIAL PURCHASERS SHOULD MAKE THEIR OWN ENQUIRIES AS TO THE ACCURACY OF THIS FLOOR PLAN.